

Original MINI accessories.

Installation Instructions.



Aerodynamic Package Retrofit

MINI One (R56)

MINI Diesel (R56)

MINI Cooper (R56)

MINI Cooper S (R56)

Retrofit	51 19 0 418 197	Aerodynamic package, all colors, painted, MINI Cooper/MINI ONE
kit no.:	51 19 0 418 200	Aerodynamic package, primed, MINI Cooper/MINI ONE
	51 19 0 418 207	Aerodynamic package, all colors, painted, diesel
	51 19 0 418 201	Aerodynamic package, primed, diesel
	51 19 0 418 204	Aerodynamic package, all colors, painted, MINI Cooper S
	51 19 0 418 202	Aerodynamic package, primed, MINI Cooper S
	51 19 0 418 198	Aerodynamic package, primed, with PDC, painted, MINI Cooper/MINI ONE
	51 19 0 418 199	Aerodynamic package, primed, with PDC, painted, MINI Cooper/MINI ONE
	51 19 0 418 208	Aerodynamic package, all colors, with PDC, painted, diesel
	51 19 0 418 206	Aerodynamic package, with PDC, primed, diesel
	51 19 0 418 205	Aerodynamic package, all colors, with PDC, painted, MINI Cooper S
	51 19 0 418 203	Aerodynamic package with PDC, primed, MINI Cooper S

Installation time

The installation time is approx. 1.5 hours, but may vary depending on the condition of the car and the equipment in it.

Important information

These installation instructions are primarily designed for use within the MINI dealership organization as well as by authorized MINI service companies.

In any event, the target group for these installation instructions is specialist personnel trained on MINI cars with the appropriate specialist knowledge.

All work must be completed using the latest MINI repair manuals, circuit diagrams, servicing manuals and work instructions, in a rational order, using the prescribed tools (special tools) and observing current health and safety regulations.

To avoid unnecessary extra work and/or costs, if any installation or function problem occurs, after a brief troubleshooting session (approx. 0.5 hours), please contact the following:

- 1. Either your national subsidiary or your regional office, or**
- 2. The support team via the Aftersales Assistance Portal (ASAP), using the optional technical parts support application**

Specify the chassis number and the part number of the installed retrofit kit and give a precise description of the problem.

Do not archive the hard copy of these installation instructions since daily updates are made by ASAP!
See ASAP for explanations of the pictograms.

All pictures show LHD cars; proceed accordingly on RHD cars.

Pictograms



Denotes instructions that draw your attention to dangers.



Denotes instructions that draw your attention to special features.

◀ Denotes the end of the instruction or caution text.

Installation information

The installation instructions describe the procedure on the left-hand side of the vehicle only.

The same procedure should be followed analogously on the right-hand side of the vehicle.

Stow the pieces (bolts and expander rivets) safely after removal. They will be required for the assembly of the retrofit parts.

The fog lights and the PDC sensors are taken from the car and merely fitted to the retrofit parts according to the **TIS**.

In the MINI Cooper S, the rear fog lights are taken from the car.

The rear fog lights and the necessary connectors are included as a separate parts kit for the following types of car:

MINI Cooper, MINI Diesel and MINI One.

Painting instructions

The PDC sensors taken from the car must not be painted over. Painted sensors can be ordered from the ETK (electronic parts catalog).

Component parts do not have to be primed before painting.

When painting, comply with the MINI painting instructions.

Structured parts are not painted.

List of optional equipment

SA 507 PDC (Park Distance Control)

Special tools required

None

Contents

Chapter	Page
1. Parts overview - side sill panel	4
2. Parts overview - front bumper	5
3. Parts overview - rear bumper	6
4. Preliminary work	8
5. Completing sill trim	9
6. Completing front bumper	11
7. Completing rear bumper	13

1. Parts overview - side sill panel

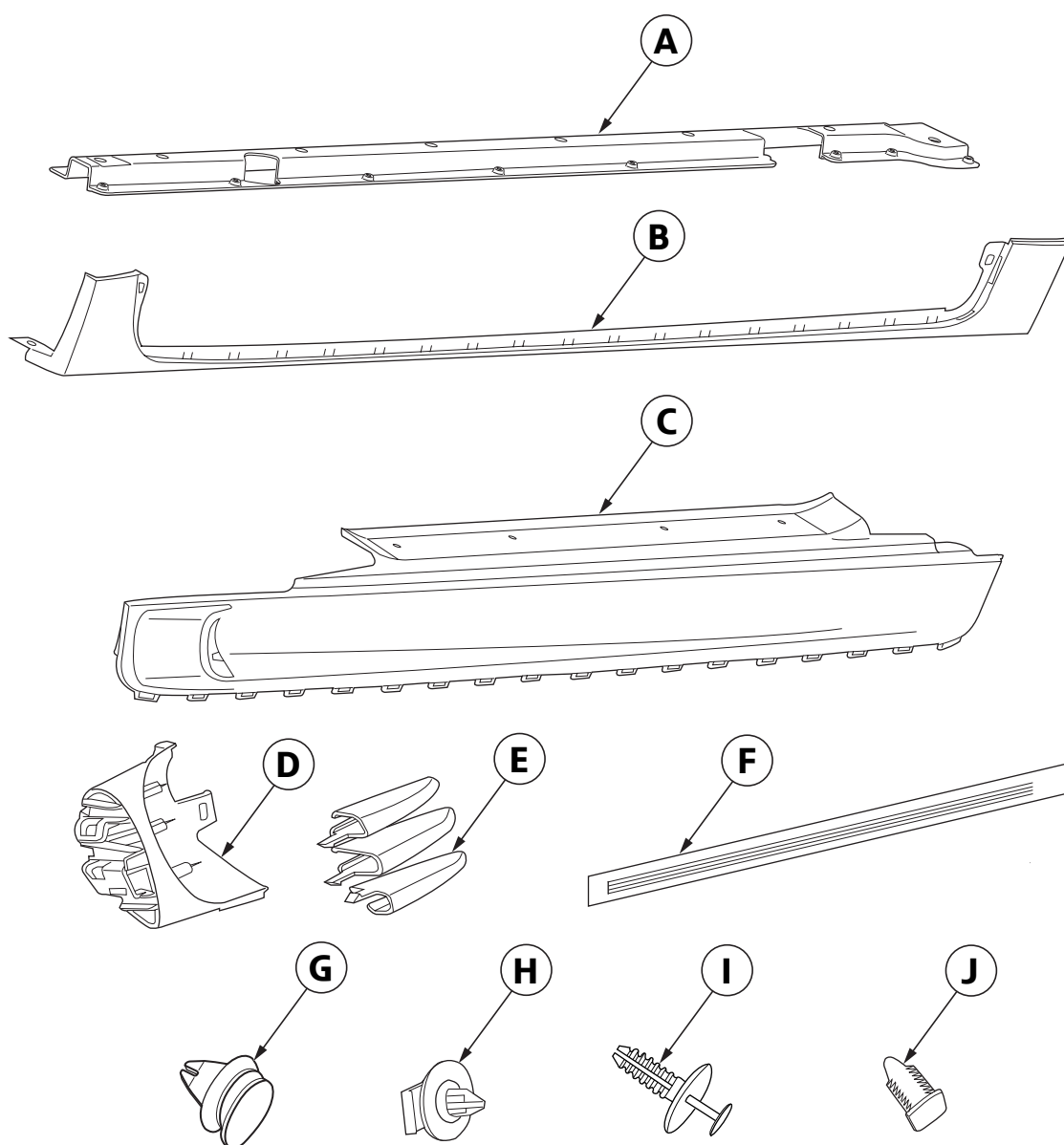

056 0100 E

Legend

- | | |
|---|-------------------------------------|
| A Adapter retainer (2 pieces) | G Clip, black (18 pieces) |
| B Lower sill trim (2 pieces) | H Clip, white (4 pieces) |
| C Upper sill trim (2 pieces) | I Expander rivet (18 pieces) |
| D Side sill air inlet bracket (2 pieces) | J Clip, black (8 pieces) |
| E Side sill air inlet insert (2 sets) | |
| F Door cutout trim (2 pieces) | |

2. Parts overview - front bumper

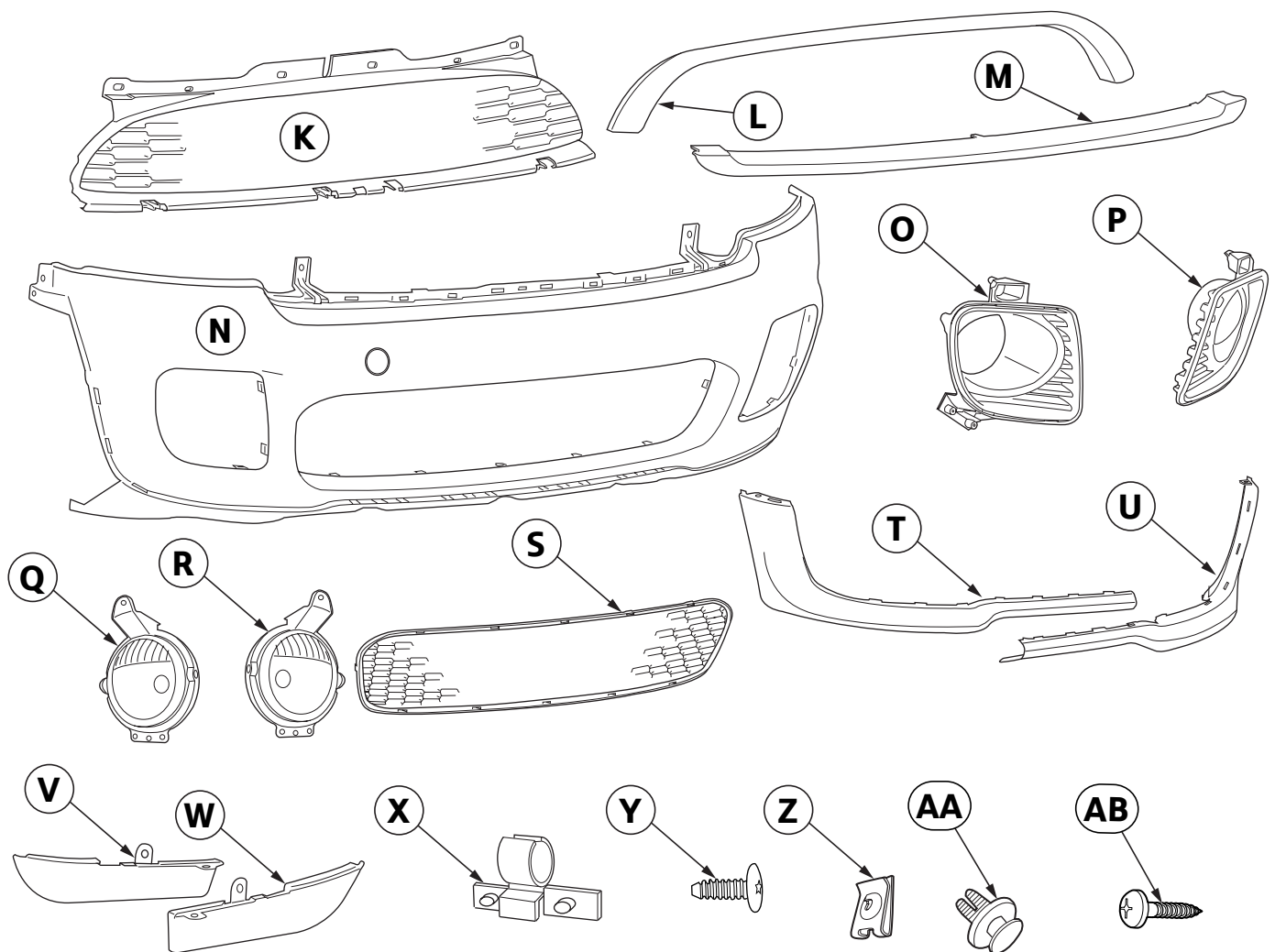

056 0101 E

Legend

- K** Upper air inlet grille (1 piece)
- L** Upper air inlet trim (1 piece)
- M** Air inlet trim (1 piece)
- N** Front bumper section (1 piece)
- O** Right fog light cover (1 piece)
- P** Left fog light cover (1 piece)
- Q** Right fog light (1 piece),
not included in parts kit, is taken from the car
- R** Left fog light (1 piece),
not included in parts kit, is taken from the car
- S** Lower air inlet grille (1 piece)

- T** Right spoiler (1 piece)
- U** Left spoiler (1 piece)
- V** Right ram-air lip (1 piece)
- W** Left ram-air lip (1 piece)
- X** Temperature sensor bracket (1 piece)
- Y** Self-tapping screw (2 pieces)
- Z** Sheet metal nut (2 pieces)
- AA** Expander rivet (4 pieces)
- AB** Screw (4 pieces)

3. Parts overview - rear bumper

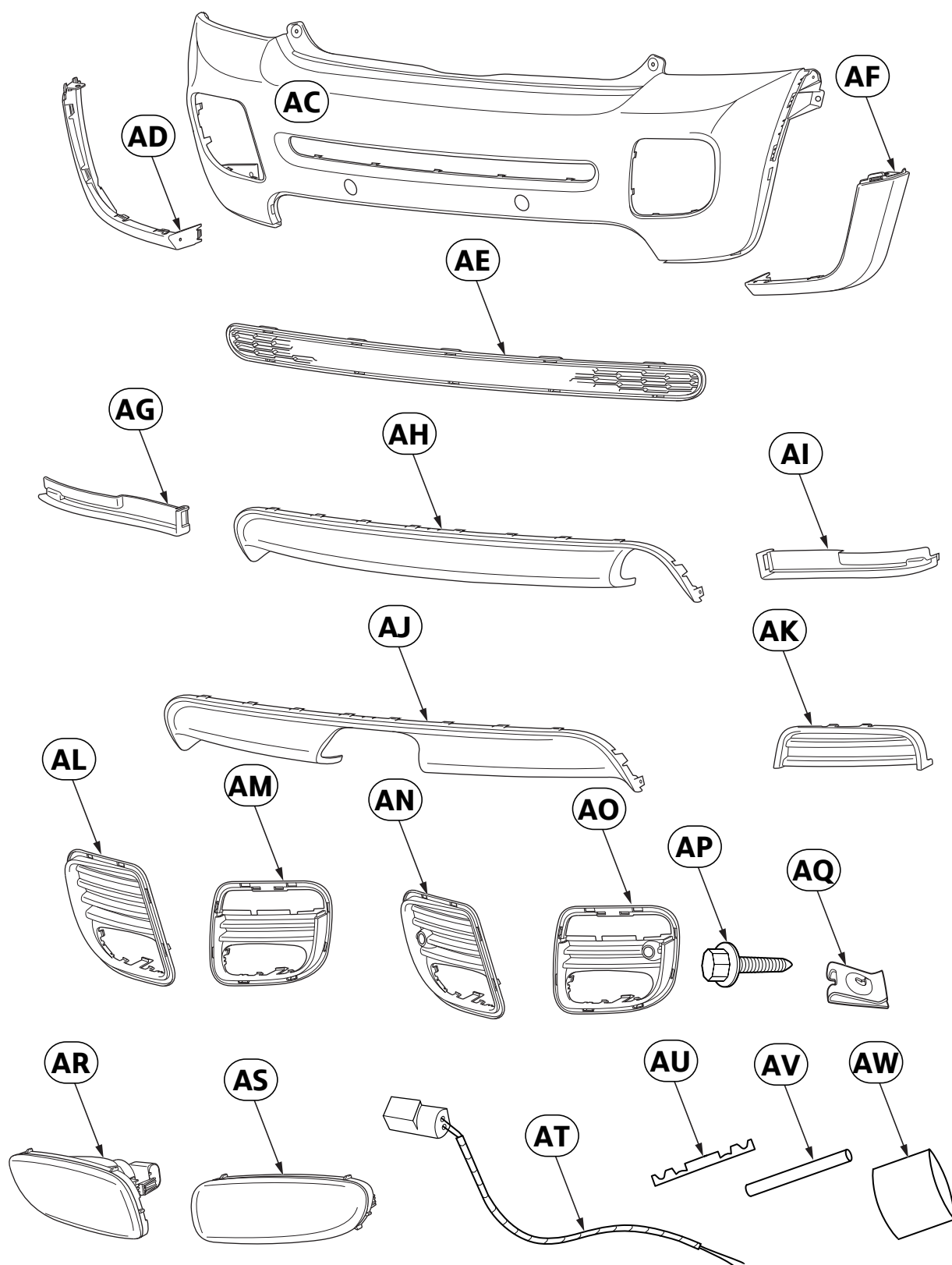

056 0102 E

3. Parts overview - rear bumper

Legend

AC	Rear bumper section (1 piece)	AN	Left air outlet grille with PDC (1 piece)
AD	Left extension (1 piece)	AO	Right air outlet grille with PDC (1 piece)
AE	Central air outlet grille (1 piece)	AP	Self-tapping screw with washer (2 pieces)
AF	Right extension (1 piece)	AQ	Sheet metal nut (2 pieces)
AG	Left bulkhead partition (1 piece)	AR	Left rear fog light (1 piece), not for MINI Cooper S
AH	Bumper panel, not for MINI Cooper S (1 piece)	AS	Right rear fog light (1 piece), not for MINI Cooper S
AI	Right bulkhead partition (1 piece)	AT	Wiring harness adapter (1 piece), not for MINI Cooper S
AJ	Bumper panel, for MINI Cooper S only (1 piece)	AU	Butt connector (2 pieces), not for MINI Cooper S
AK	Towing eye cover (1 piece)	AV	Shrink-fit hose (2 pieces), not for MINI Cooper S
AL	Left air outlet grille (1 piece)	AW	Shrink-fit hose (1 piece), not for MINI Cooper S
AM	Right air outlet grille (1 piece)		

4. Preliminary work

	TIS No.
Remove the following components in advance	
Side sill trim	-- -- ---
Front bumper	51 11 156
Chrome strip of air inlet grille	51 13 003
Rear bumper	51 12 156

5. Completing sill trim

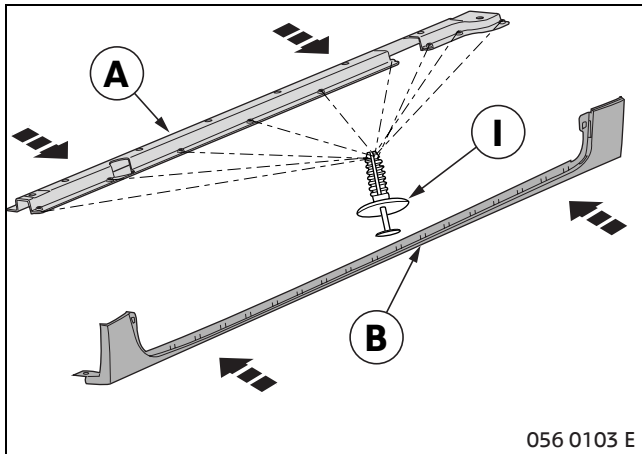

Place adapter fixture **A** on lower sill trim **B**.
Insert and lock expander rivets **I** in the holes provided.

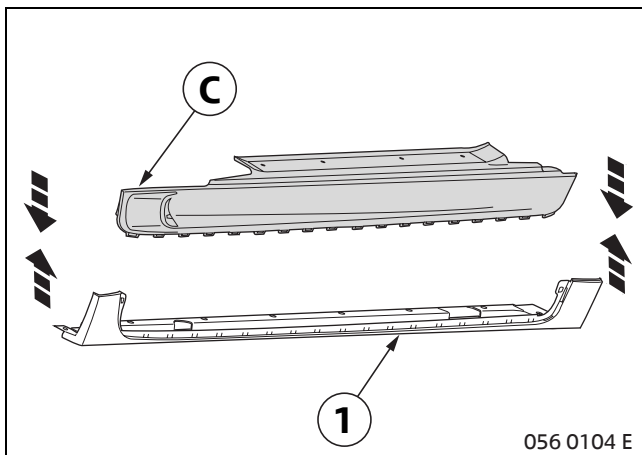

Place upper sill trim **C** on the two previously connected components (1) and click into place.

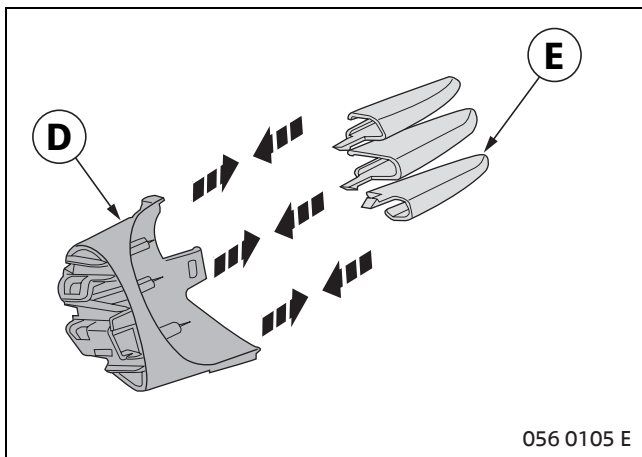

Insert air inlet inserts **E** into the sill air inlet mounting support **D**.

Inserts **E** are numbered and are inserted as follows:

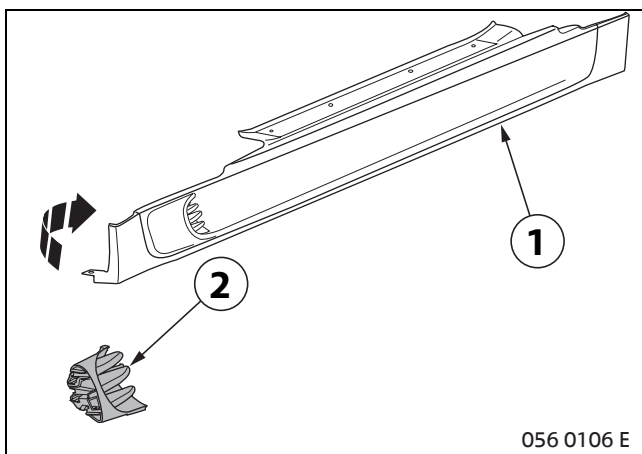

Insert complete sill air inlet (2) into the recessed opening from the back of the sill trim (1) and click into place.

5. Completing sill trim

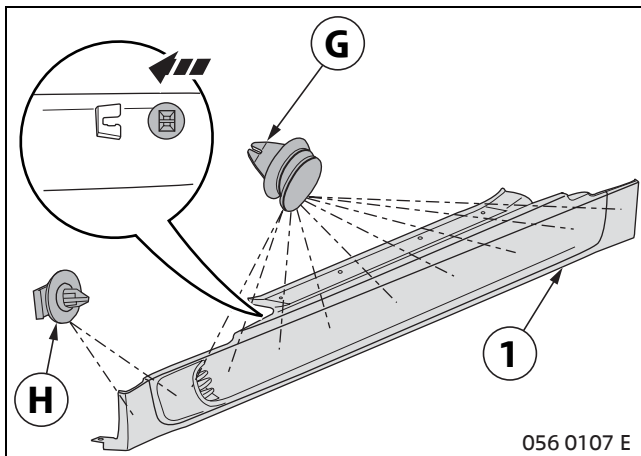

Push white clip **H** and black clip **G** into the retaining grooves provided on the back of the sill trim (1).

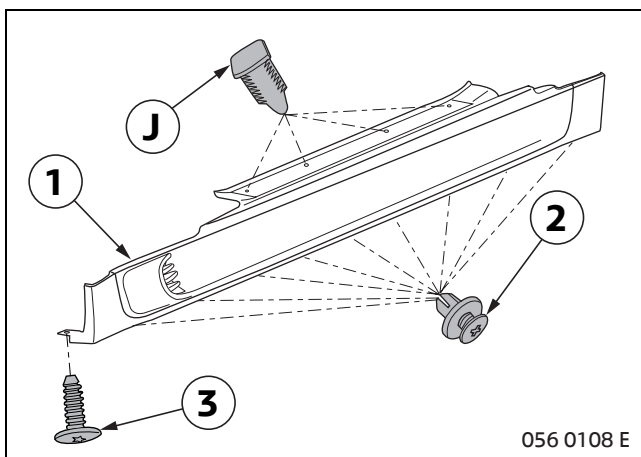

Fit the sill trim (1) on the car according to the **TIS**:

- Use the expander rivets (2) and
- the torx screws (3) from the removal.

Insert clips **J** on the top of the sill.

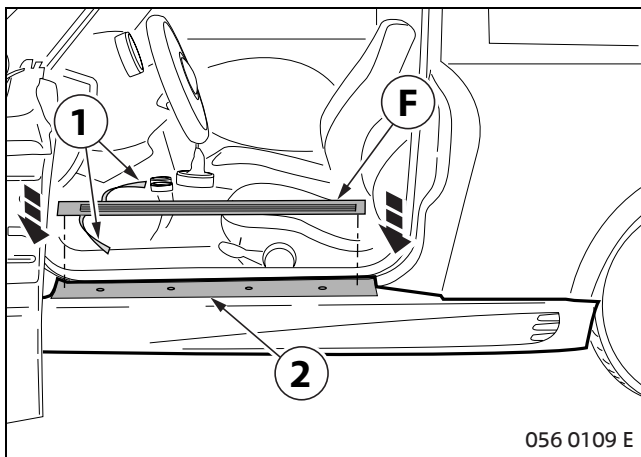

Remove the protective film from the adhesive pad (1) on the bottom of door cutout trim **F**.

Place trim **F** on the top of the sill trim (2) and press firmly.

6. Completing front bumper

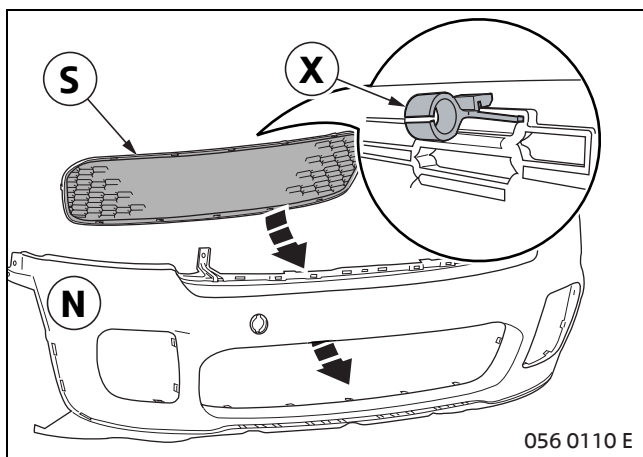

Insert air inlet grille **S** in the front bumper panel **N** and lock into place.

Insert temperature sensor bracket **X** in air inlet grille **S**.

While mounting bumper **N** on the car, insert temperature sensor in bracket **X**.

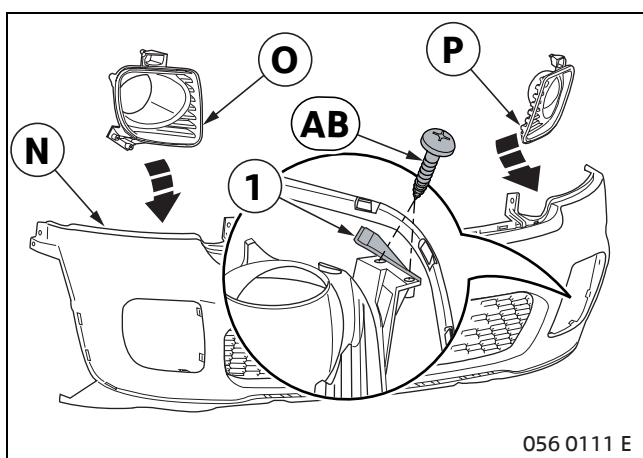

Insert fog light trim **O** and fog light trim **P** in front bumper section **N** and lock into place.

Unfold film hinge (1) of fog light trim **O/P** and fasten with bolts **AB**.

Remove fog lights from the series bumper trim and install in bumper section **N**.

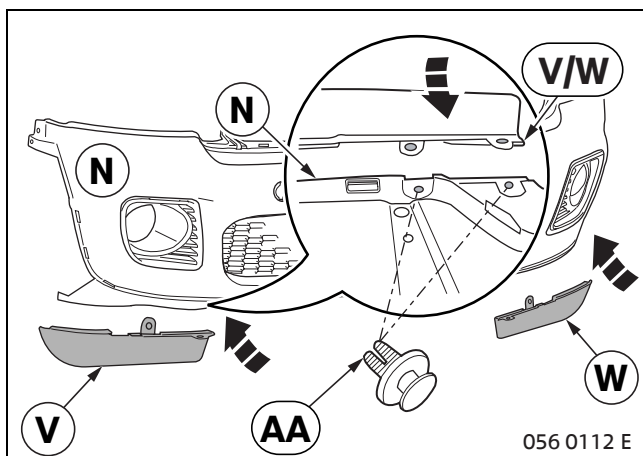

Place ram-air lip **V** and ram-air lip **W** on the bottom of front bumper section **N** and connect with expander rivet **AA**.

L1 - Upper left
L2 - Center left
L3 - Lower left

R1 - Upper right
R2 - Center right
R3 - Lower right

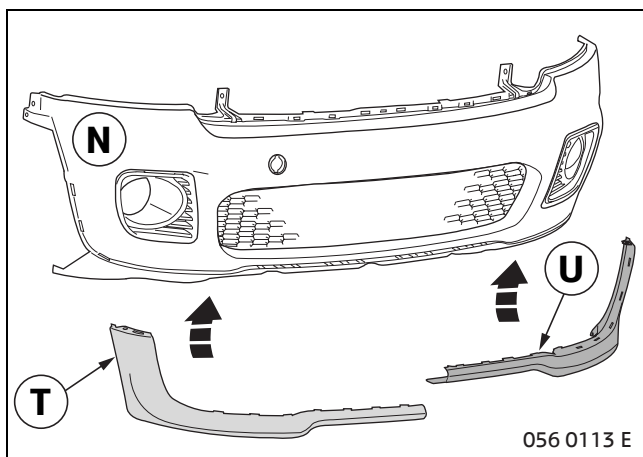

Insert front right spoiler **T** and front left spoiler **U** on the underside of front bumper section **N** and click into place.

6. Completing front bumper

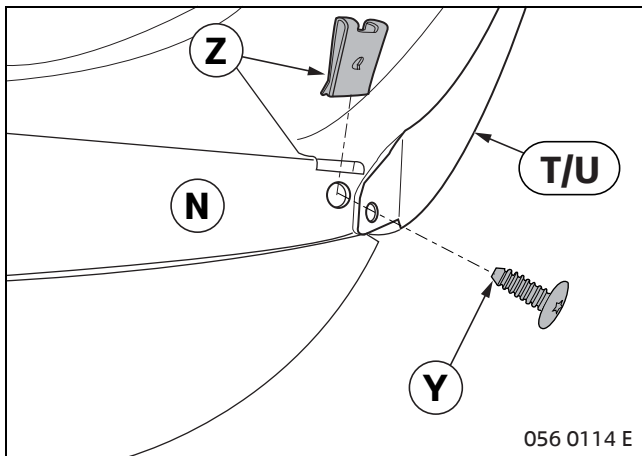

Insert sheet metal nut **Z** in the locating plate on bumper **N**. Attach spoiler **T/U** to the bumper with self-tapping screw **Y**.

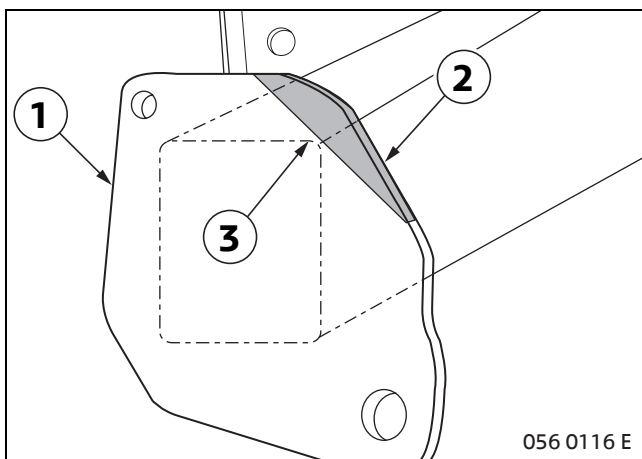

For MINI Cooper only.

Trim the front right and left bumper support member.

Remove the marked area (2) on the bumper support member (1) down to the radius (3).

 Trim the front left bumper support member in the same way, but as the mirror image. ◀

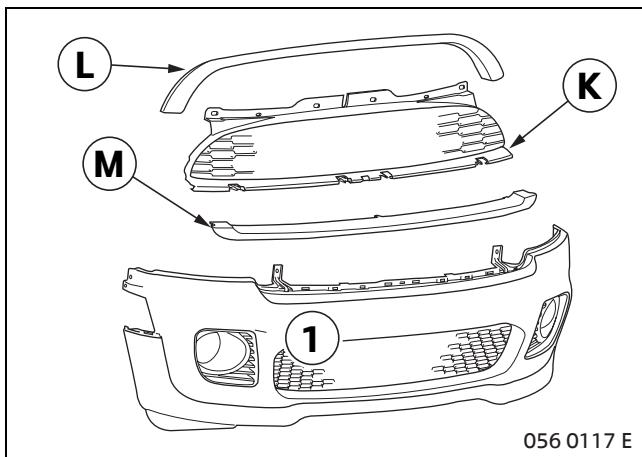

For all vehicles.

Mount the pre-assembled bumper (1) plus air inlet grille **K** and air inlet trims **L/M** on the car according to the **TIS**.

7. Completing rear bumper

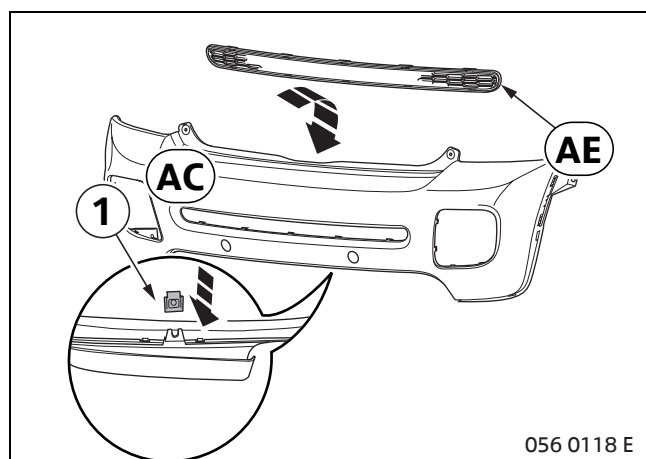

Insert air outlet grille **AE** in bumper trim **AC** from the inside and click into place.

Use sheet metal nut (1) (right bracket next to exhaust) from series bumper.

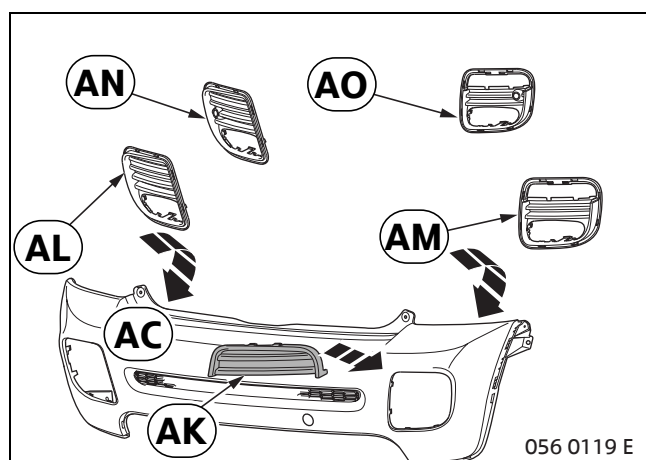

For vehicles with SA 507 (PDC) only.

Insert right air outlet grille **AO** and left air outlet grille **AN** in bumper trim **AC** from the inside and click into place.

For vehicles without SA 507 (PDC) only.

Insert right air outlet grille **AM** and left air outlet grille **AL** in bumper trim **AC** from the inside and click into place.

For all vehicles.

Insert towing eye cover **AK** into right air outlet grille **AM/AO** from the outside and click into place.

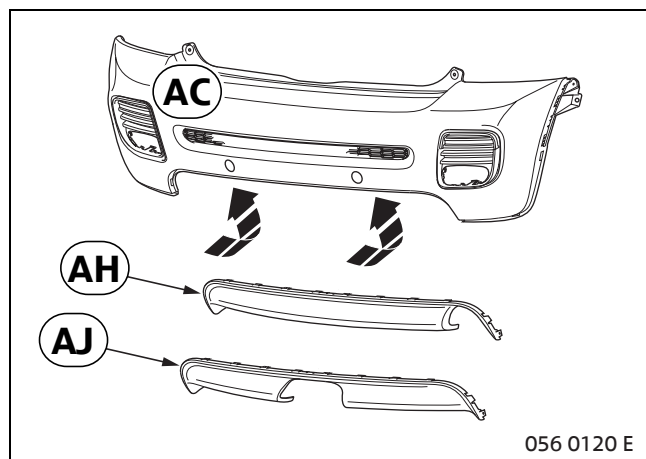

For MINI Cooper S only.

Insert bumper panel **AJ** in bumper trim **AC** from the inside and click into place.

For all other vehicles.

Insert bumper panel **AH** in bumper trim **AC** from the inside and click into place.

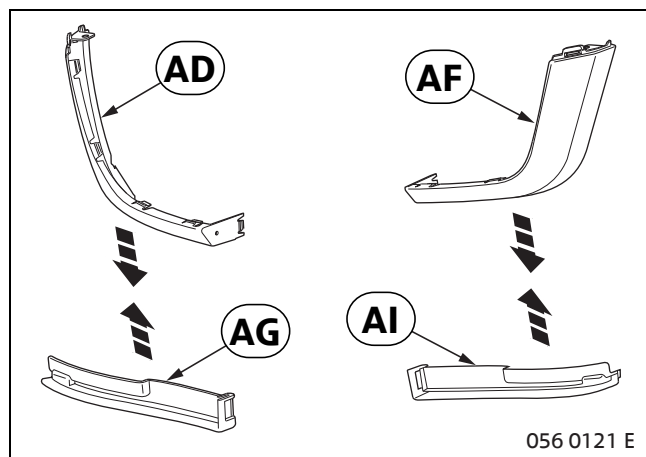

For all vehicles.

Put left bulkhead partition **AG** onto left extension **AD** and click into place.

Put right bulkhead partition **AI** onto right extension **AF** and click into place.

7. Completing rear bumper

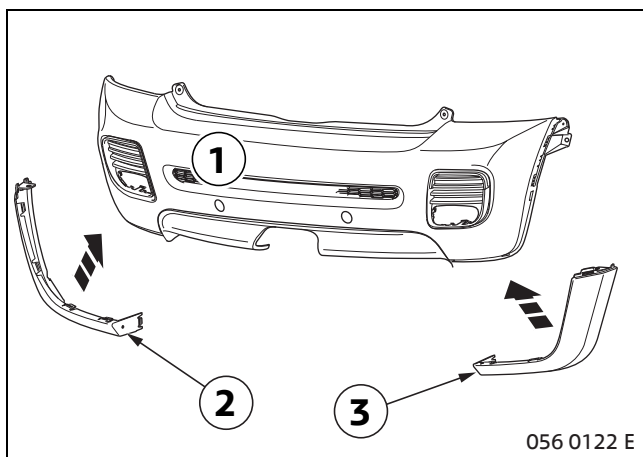

Put the extensions complete with the bulkhead partitions (2) and (3) onto the bumper section (1) from the left and right respectively and click into place.

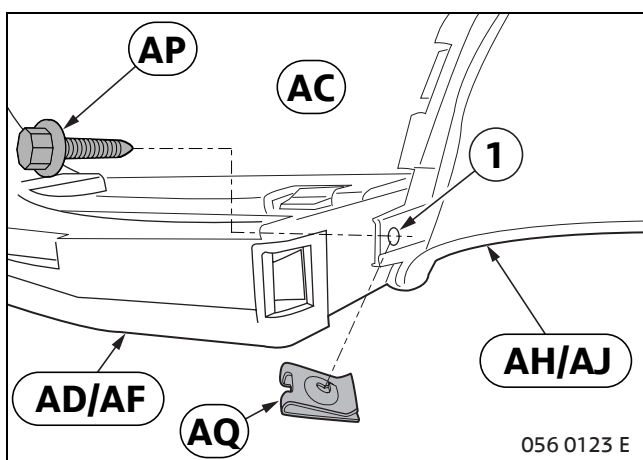

View shows the inside of bumper section **AC**.

Make the connection between **AD/AF** and bumper trim **AH/AJ** as follows:

- Put sheet metal nut **AQ** onto the lug (1) of bumper trim **AH/AJ**
- Connect extension **AD/AF** and bumper trim **AH/AJ** using hexagon bolt **AP**.

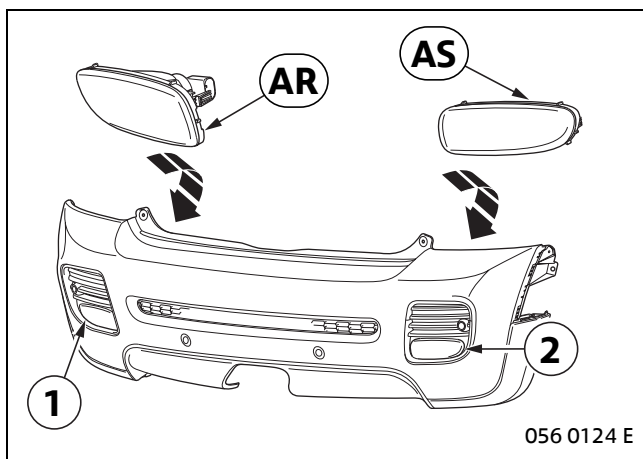

Clip rear fog lights **AR/AS** into left/right air outlet grille (1/2) from the inside.

For MINI Cooper S only.

Take rear fog lights from series bumper.

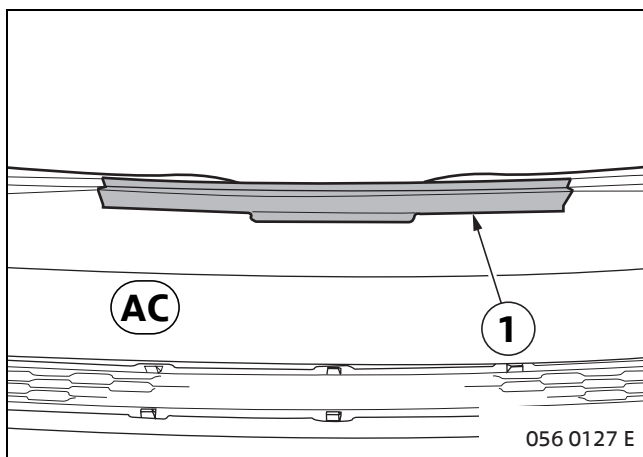

Remove guide rail (1) from series bumper and assemble on retrofit bumper **AC**.

7. Completing rear bumper

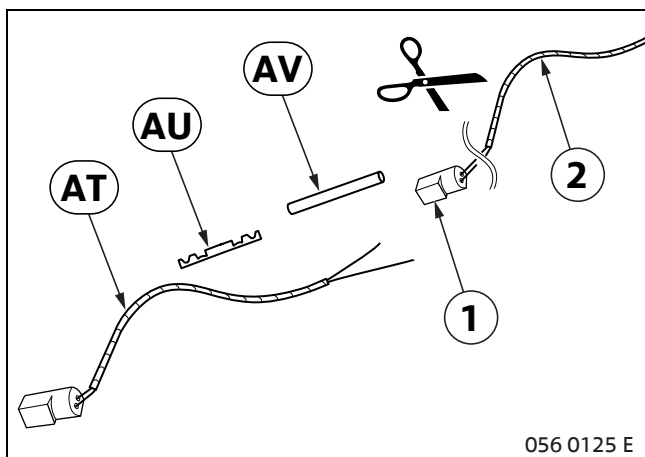

Not for MINI Cooper S.

Disconnect plug (1) from rear fog light car wiring harness (2).

Connect wiring harness adapter **AT** to rear fog light car wiring harness (2) with butt connector **AU** and shrink-fit hose **AV**.

For **LHD** vehicles, connect left rear fog light **AR**.

For **RHD** cars, connect right rear fog light **AS**.

Seal the connector housing of the rear fog light that is **not** connected with shrink-fit hose **AW** so it is waterproof.

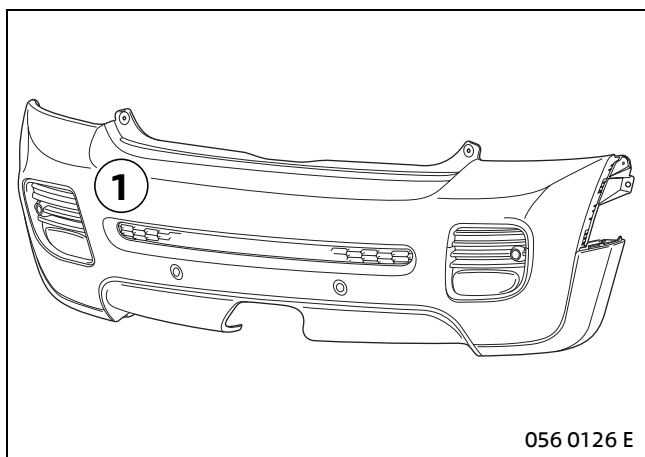

For vehicles with SA 507 (PDC).

Insert PDC sensors in bumper trim.

For all vehicles.

Mount pre-installed bumper section (1) on the vehicle according to the **TIS**.